



**AMATHUS**  
B E A C H - H O T E L  
L I M A S S O L C Y P R U S

CONFERENCES, MEETINGS & EVENTS



LEADING  
HOTELS®



WELCOME TO THE  
AMATHUS BEACH HOTEL  
LIMASSOL - CYPRUS



## THE HOTEL

The Amathus Beach Hotel is a 5-star beachfront resort, member of the 'Leading Hotels of the World' on the outskirts of Limassol with a unique seafront, 4000m2 of mature landscaped gardens and a secluded sandy beach area.







## LIMASSOL

A cosmopolitan sea-side town with a unique identity, based on its rich history and culture. The town's special characteristics and wide variety of options include cycling, bird watching, mini cruises to nearby destinations, Byzantine churches, wine routes and much more.

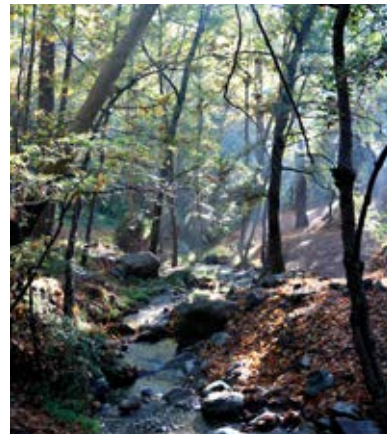



## RESTAURANTS & BARS

Amathus gastronomy comes in different flavours. International and award-winning speciality cuisine, snacks and drinks are served both indoors and outdoors. Each restaurant, bar and lounge has its own style and ambience, which give every bite the touch of perfection.





## ROOMS & SUITES

Five-star accommodation is at the core of Amathus hospitality, with different room types to match individual preferences. All 239 luxury rooms and suites welcome you with generous sunshine and the amenities you would expect from a world-class hotel.





## CONFERENCES

The Amathus Conference Centre provides upscale business facilities that distinguish it as a prominent business venue for corporate events. Drenched by natural daylight the hotel's conference rooms on the mezzanine floor are equipped and decorated to accommodate any corporate or social event.













# MAIN CONFERENCE CENTRE

## Rooms, Dimensions & Capacities

Rooms	Dimensions		Capacities						
Main Conference Centre	Metres LxW	Sq. Metres	 Theatre	 U-Shape	 Classroom	 Cocktail Reception	 Dinner Dance (round tables)	 Banquet (long tables)	 Cabaret Style
Demetra	22.8x19.8	442	350	56	180	500	250	300	156
Ares	15.3x12	176	110	28	80	150	80	100	60
Demetra & Ares	22.8x19.8+15.3x12	618	N/A	N/A	N/A	600	350	450	N/A
Hermes, Aphrodite & Poseidon	22.8x6.3	143.5	110	40	80	90	N/A	N/A	N/A
Hermes & Aphrodite or Aphrodite & Poseidon	15.2x6.3	96	70	24	56	60	N/A	N/A	N/A
Hermes or Aphrodite or Poseidon	7.6x6.3	47.8	30	12	20	30	N/A	N/A	N/A



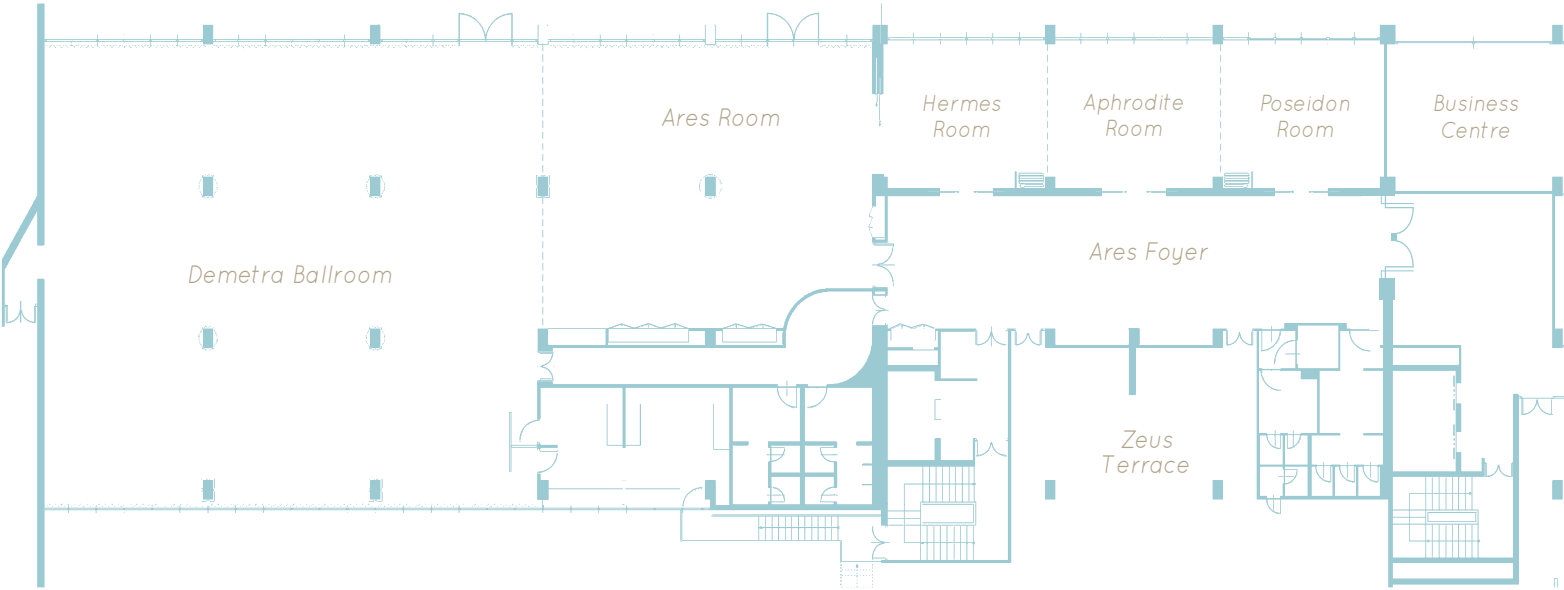



MEZZANINE FLOOR





# ATHENAEUM CONFERENCE ROOMS

## Rooms, Dimensions & Capacities

Rooms		Dimensions		Capacities						
Athenaeum Conference Rooms	Metres LxW	Sq. Metres	 Theatre	 U-Shape	 Classroom	 Cocktail Reception	 Dinner Dance (round tables)	 Banquet (long tables)	 Cabaret Style	
All Athenaeum Rooms	30x6.5	195	120	N/A	100	220	N/A	N/A	N/A	
Athenaeum Rooms 1+2+3	22.5x6.5	146.2	110	40	80	150	N/A	N/A	N/A	
Athenaeum Rooms 1+2	15x6.5	97.5	70	24	56	100	N/A	N/A	36	
Athenaeum Rooms 1 or 2 or 3	7.5x6.5	49	30	12	20	30	N/A	N/A	12	
Athenaeum Room 4	8x7.5	60	30	12	20	30	N/A	N/A	12	
Athenaeum Terrace						200	N/A	N/A	N/A	

MEZZANINE FLOOR

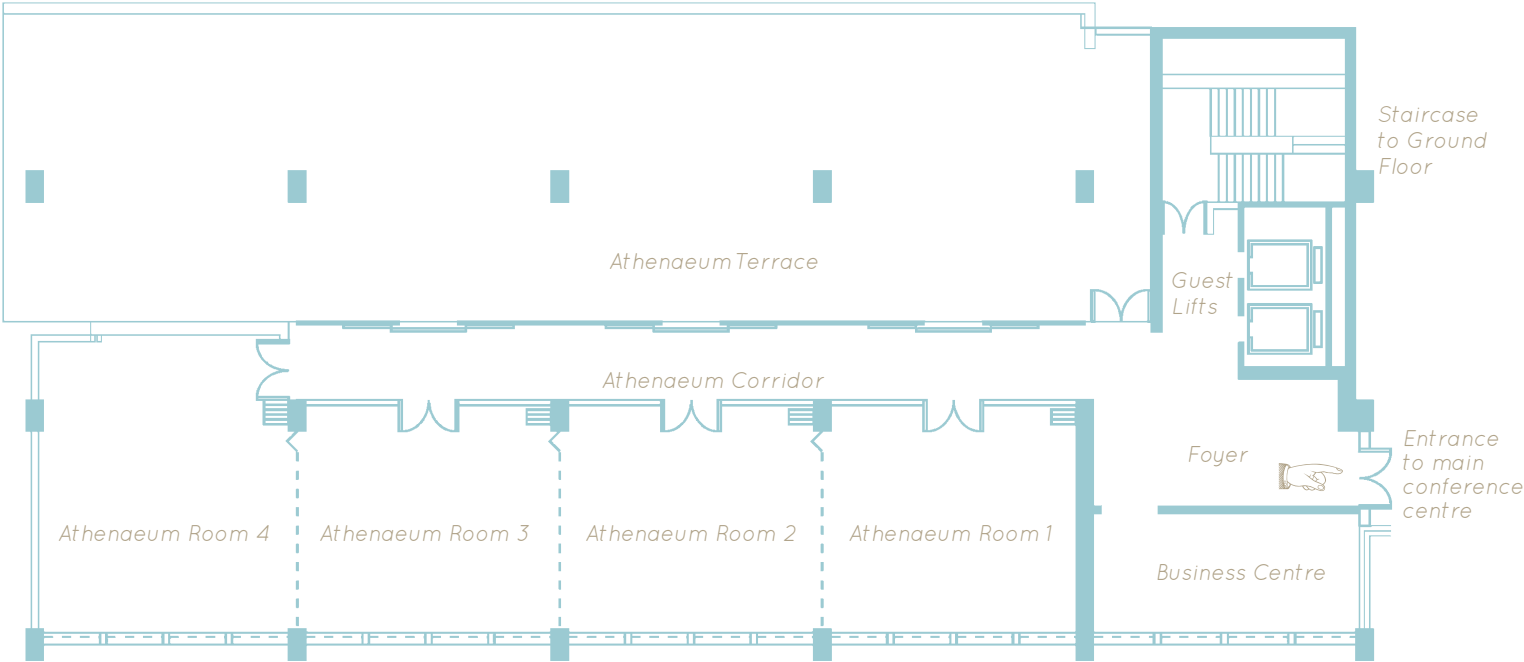

## FACILITIES

### AUDIO SYSTEMS

- Public address system with lectern and microphones  
(lapel, wireless or desk type)

- Simultaneous interpretation system

for up to sixteen languages with booths, ear phones and  
microphones (External contracting)

- Hand-held wireless microphones

- Lapel mic

- Microphones with lead and stand

### VISUAL AIDS

- LCD Data computer/video projector

- Back screen projection equipment (External contracting)

- Video Camera Recorder (External contracting)

- Fixed and portable screens

- Flipcharts

- Photographer (External contracting)

- Videoconferencing (External contracting)

- Voting system (External contracting)

- LCD – Plasma Monitors (External contracting)



## OTHER CONFERENCE ROOM FACILITIES

- All rooms with natural daylight
- All rooms fully air-conditioned
- Soundproof movable partitions
  - Lighting dimmers
- Ceiling-mounted loud-speakers
  - Direct telephone lines
- Ceiling-mounted screens
  - Flipcharts
  - Laser beam pointers
  - Black-out curtains
- Electric current: 240V AC50 cycle
  - Stage lighting system

## BUSINESS CENTRE FACILITIES

- Secretarial services (Upon request)
  - Fax services
- Photocopying/laminating services
  - Guest Relations services
  - Mail & courier services
  - Conference name tags
  - Internet/e-mail services
    - Desktop computers
    - Laser colour printers



## BANQUETS & EVENTS

The fully renovated multi-purpose function hall with an area of 618m<sup>2</sup> can be arranged, equipped and decorated to accommodate any corporate or social event.













## FOOD & BEVERAGE

A proven track record of hosting successful high-profile events demonstrates the balance of outstanding facilities and the services of an experienced food & beverage team.





## FACT SHEET

### *General Information*

**Classification:** 5 Stars

**Member of:** The Leading Hotels of the World

**No. of rooms:** 239

**No. of guest lifts:** 3

**Postal Address:** P.O.BOX 50513 Limassol - Cyprus

**Telephone:** +357-25832000

**Telefax:** +357-25832540

**E-Mail:** amathusl@amathushotel.com

**Internet Home Page:** <http://www.amathuslimassol.com>

### *Gds Codes Under The Leading Hotels Access Code*

**Amadeus:** LCA 085

**Galileo-Apollo:** 8569

**Sabre:** 10845

**Sita-Sahara:** NIC 0850

**System One:** LCA 085

**Worldspan:** 0850

### *Public Areas*

**Cyan Restaurant:** á la carte restaurant, offer local delicacies and international favourites

**Grill Room:** á la carte restaurant, offers Special Grill Cuts Cooked in Woodfired-Oven

**Kalypso Restaurant:** Breakfast, lunch and all day snacks

**La Terrazza:** scrumptious themed buffet dining under a star-studded sky

**Limanaki Fish Restaurant:** Seaside starlit Fish restaurant

**Lighthouse Bar:** A uniquely cool circular bar built with backlit whitewashed sea cobbles

**Nubar:** Modern and cozy cocktail bar with terrace overlooking the sea & gardens

**Helios & Fresh Bar:** Pool-Beach Bar with fresh juices

**Shopping Arcade:** Boutique-Jewellery-Souvenirs

**Hairdressers:** Unisex

**Meeting rooms:** Demetra, Ares, Hermes, Aphrodite, Poseidon, Athenaeum Rooms

### *Sports, Fitness, Beauty & Leisure*

Two outdoor fresh water swimming pools

*(One is dedicated for families with two water slides and a water toy)*

Large sunlit heated indoor pool with sea water- Jacuzzi pool  
*(Whirlpool)*

Two floodlit tennis courts - Table-Tennis

Fully equipped Life Fitness Gym-Room - Aerobics Hall

Jacuzzi Bath, Steambath, Sauna & Massage Rooms

Amathus Spa & Wellness Centre with over 1,500 square meters of opulent, pampering space

Hydrotherapy Bath - Mud Wrap - Aromatherapy

Electronic Games Room - Pool Tables

### *Guest Services Information*

**Check-in:** 14.00 hrs

**Check out:** 12.00 Noon

**Breakfast:** 07.00-10.00 hrs

**Lunch:** 12.30-15.00 hrs

**Dinner:** 19.30-22.30 hrs

**Room Service:** 24.00 hrs

**Air conditioning:** Central heating - cooling system

**Electric current:** 220/240 V AC 50 Cycles

**Laundry and valet service**

**All major Credit cards accepted**

### *Services On Request*

Babysitting

Medical Services

Floral Services

Secretarial Services

Air & Sea-Cruise Reservations

Sightseeing Tours - Car Rental



### *Guest Rooms*

96 Superior Twins Inland View

103 Superior Twins Sea View

1 Presidential Suite, Sea View

3 Amathunta Suites, Sea View

9 Junior Suites, Sea View with private pool

27 Junior Suites, Sea View

Individually controlled air conditioning

International direct dial telephone

Minibar - Radio / taped music system

Safe deposit box - Full length mirror

Colour TV with satellite, local and video channels, Pay TV,

Internet, Playstation, Tea and coffee making facilities.

Spacious balcony

(Superior Inland View Rooms do not have balcony)

Bathroom with shaver outlet, telephone extension and hairdryer

### *Distance*

**Beach:** on the beach

**City Centre:** 9 km - 6 miles or 10 minutes by car

**Larnaca Airport - Town:** 58 km - 36 miles or 40 minutes by car

**Paphos Airport:** 69 km - 43 miles or 50 minutes by car

**Paphos Town:** 75 km - 47 miles or 45 minutes by car

**Limassol Harbour:** 19 km - 12 miles or 20 minutes by car

**Nicosia Town:** 69 km - 43 miles or 45 minutes by car

**Troodos Mountain:** 57 km - 36 miles or 50 minutes by car

**Curium Theatre:** 27 km - 17 miles or 30 minutes by car

**Kolossi Castle:** 22 km - 14 miles or 25 minutes by car

**Aphrodite Hills Golf Course:** 47 km - 29 miles or 35 minutes by car





AMATHUS  
BEACH - HOTEL  
LIMASSOL CYPRUS





OPERATORS AND  
OWNERS OF LUXURY  
HOTELS

75 Amathounta Avenue, 4532 Limassol, Cyprus  
P O Box 50513, 3606 Limassol, Cyprus

E: [amathusi@amathushotel.com](mailto:amathusi@amathushotel.com)  
[www.amathuslimassol.com](http://www.amathuslimassol.com)

T: +357 2583 2000  
F: +357 2583 2540